

■ Pipe clamp Trabant Inox 20x1,5 48 - 52 mm M8/M10 TPE

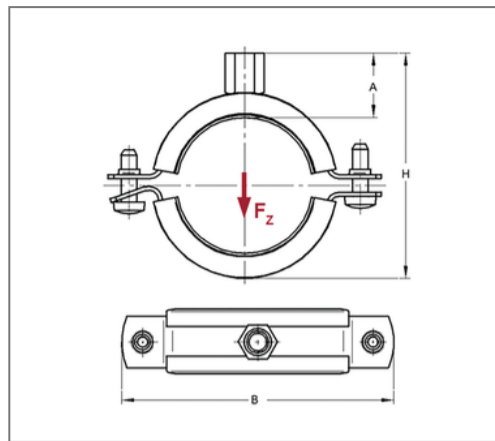

Commercial details

| | |
|---------------|---------------|
| Part no. | 051003052 |
| EAN/GTIN | 4250928453891 |
| Packing unit | 50 pcs |
| Quantity unit | pcs |
| Weight | 0,103 kg/pc |
| Product group | 13-051 |
| Price unit | 100 |

QR code



Certification



Specification

| | |
|------------------|---------------------------------|
| Application area | Pipe clamp for fastening pipes. |
| Specification | two-part |
| Connection | M8/M10 |
| Closure | Snap-in closure |

Technical data

| | |
|-------------------------|--------------------------|
| Material | Stainless steel |
| Material type | V4A |
| Surrounding area | Indoor and outdoor areas |
| Insulation thickness | 4,5 mm |
| Temperature resistance | -35 °C - 100 °C |
| Sound insulation lining | TPE |

Product details

| | |
|--------------------------------|---------------------------------------------|
| Center distance S | 80,5 mm |
| Connection height A | 22,5 mm |
| Width B | 98 mm |
| Colour sound insulation lining | black |
| Height H | 76 - 81 mm |
| Material dimension | 20x1,5 mm |
| Load F _z | 0,6 kN |
| Clamping range | 48 - 52 mm |
| Outside pipe diameter inch | val.RohraußendurchmesserZoll. 1 1/2 inch |
| Closure screw | M6 |

Remark

| | |
|---------------|-----------------------------------------------|
| Delivery time | 2 working days, ex works |
| Notice | Other sizes and connection threads on demand. |