

■ Profile rail CENTUM XL 100 100 / 100 / 3 mm L= 6 m hot-dip galv.

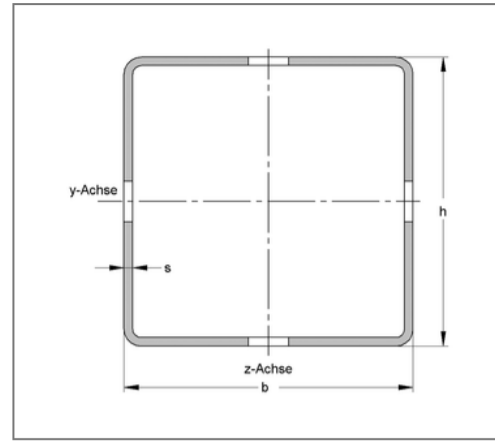
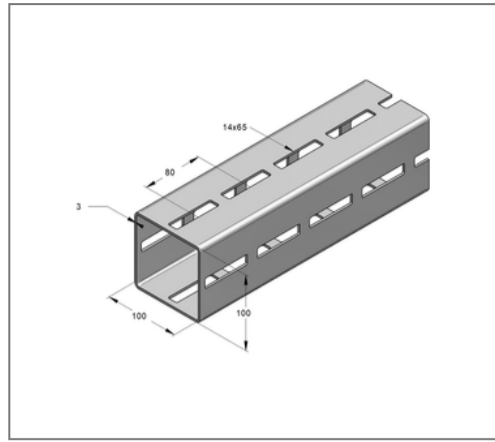
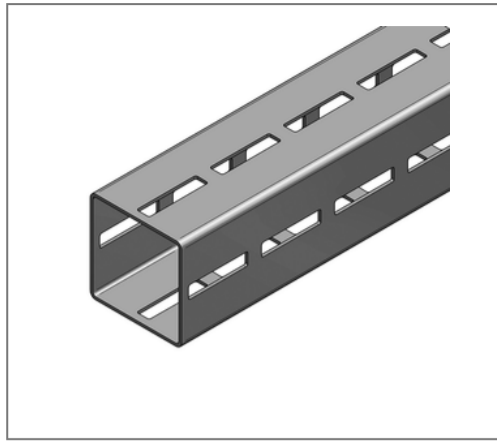

Commercial details

Part no.	16010060
EAN/GTIN	4250928436634
Packing unit	6 m
Bundle	96 m
Quantity unit	m
Weight	8,46 kg/m
Product group	14-160
Price unit	1

QR code



Certification



Specification

Application area	Heavy-duty square profile for modular industrial and plant construction.
Specification	modular system, 4-sided without raster in connection with mounting parts, torsion stiffness, high load capacity

Technical data

Material	Steel
Material type	S275
Surface	hot-dip galvanized
Corrosion category	C4 high / C5 medium
Surrounding area	Indoor and outdoor areas

Product details

Width	100 mm
Height	100 mm
Thickness	3 mm
Length	6 m
Elongated hole	14x65 mm
Area (least cross section of the profile rail)	9,73 cm ²
Axial angular impulse I_y	157,14 cm ⁴
Axial angular impulse I_z	157,14 cm ⁴
Grid dimension	80 mm
Elastic limit	275 N/mm ²
Radius of inertia i_y	4,02 cm
Radius of inertia i_z	4,02 cm
Section modulus W_y	31,43 cm ³

Product details

Section modulus W_z

31,43 cm³